

Li-Gen[®] The Next Generation of Battery Technology

Lithium Iron Phosphate (LiFePO4) Battery

PN: Li200

Features

- ◆ Using the technology of Lithium Iron Phosphate Cell, superior safety, thousands of cycles, to 100% DOD, under normal conditions.
- ◆ Built-in Automatic Protection for over-charge, over-discharge, over-current and over-temperature.
- ◆ Maintenance Free
- ◆ Internal cell balancing.
- ◆ Lighter weight: About 40% ~70% of the weight of a comparable lead acid battery.
- ◆ Wider temperature range: -20°C~60°C.
- ◆ Safety: No Hazardous Gas Generated during Charging
- ◆ 6 year Guarantee
- ◆ All the Components in the Battery can be recycled or Repurposed at the End of useful Life Saving the Environment.



Application

- ◆ UPS
- ◆ Solar & Wind Power System
- ◆ Mobility
- ◆ Electric Vehicle, E-bike, E-Rickshaw etc.
- ◆ Lighting
- ◆ Leisure and Marine

Dimensions

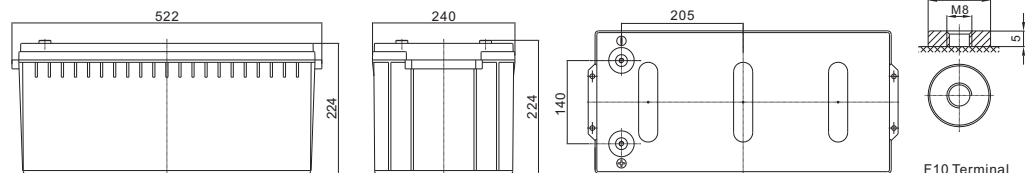

General Specifications

Electrical Characteristics	Nominal Capacity	200Ah @ 20HR
	Energy	2560Wh
	Internal Resistance	45≤mΩ
	Cycle Life	2000 Cycles @ 0.5C Charging/Discharging ,Until 80% Capacity
	Self Discharge	≤3.5% per month at 25°C
Standard Charging	Max.Charging Voltage	14.0~14.6V
	Charging Mode	At 0°C~45°C temperature, charged to 14.6V at a constant current of 0.2C5A, and then, constant voltage of 14.6V until the current is not more than 0.02C5A
	Charging Current	100Amp
	Max. Charging Current	150Amp
Standard Discharging	Max Discharging Current	200 Amp
	Max. Continuous Current	150 Amp
	Discharging Cut-off Voltage	8.0
Operating Condition	Charge Temperature	0°C to 45°C(32°F to 113°F) @60±25% Relative Humidity
	Discharge Temperature	-20°C to 60°C(-4°F to 140°F) @60±25% Relative Humidity
	Storage Temperature	0°C to 45°C(32°F to 113°F) @60±25% Relative Humidity
	Water Dust Resistance	IP55
Structure	Cell & Format	Prismatic 2P4S
	Casing	Plastic
	Dimension(L*W*H*TH)	522X240X224mm
	Weight	Approx.19.6Kg
	Terminal	M8

Li-Gen Limited Ballyduff House Ballyduff Thurles Co Tipperary Ireland Tel 00353 504 34111 Email: patrick@li-gen.net

@2019 All right reserved by Li-Gen Limited Ballyduff Thurles Co Tipperary Trademarks and logos are the property of Li-Gen Limited

Li-Gen Reserves the right to Change the above information and specification without Prior Notice

Li-Gen[®] The Next Generation of Battery Technology

Lithium Iron Phosphate (LiFePO₄) Battery

PN: Li200

Different Rate Discharge Curve @25°C

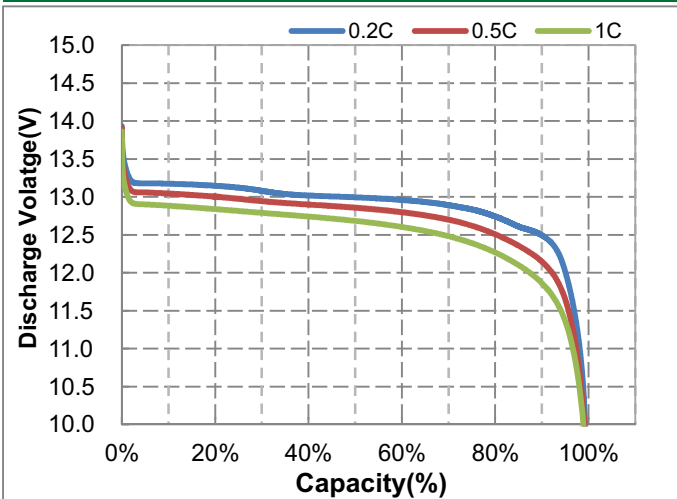

Charge Characteristics of capacity-voltage@0.2C&0.5C, 25°C

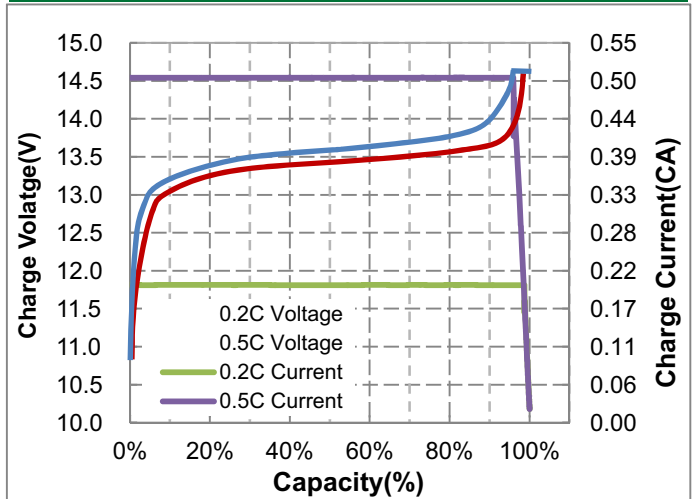

Different Temperature Discharge Curve @0.5C, 25°C

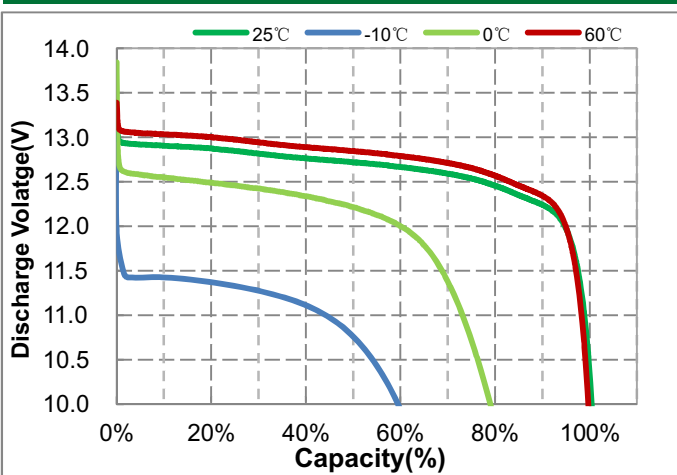

Charge Characteristics of time-voltage@0.2C&0.5C, 25°C

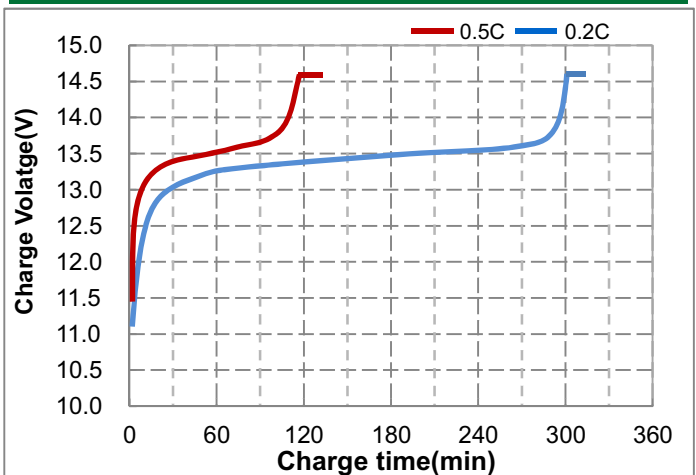

Different DOD Discharge Cycle Life Curve @0.2C, 25°C

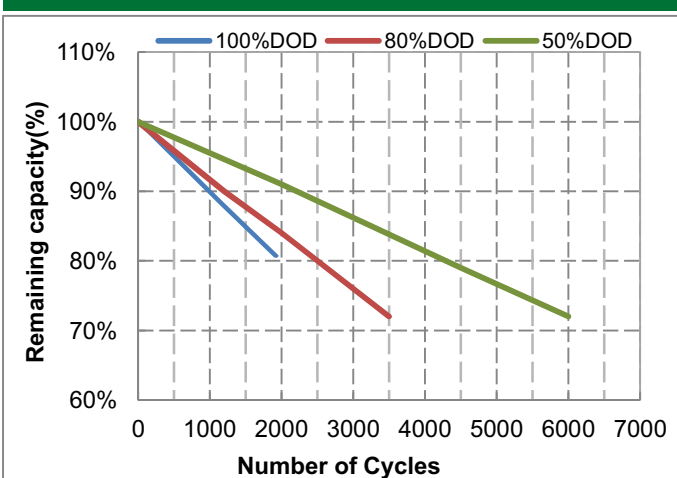

Open circuit voltage VS SOC%@25°C

